

## GA5 Standard Compartment Lock With 90° Key Removal

### Features

- Special model with 90° rotation, but in which keys can be withdrawn in both locked and unlocked positions
- Spiked locating plate provided to enable lock to be fitted into a round hole
- Keyway is oriented at 45° to 'flats' on body: adjust panel-piercing to compensate or use round hole with spiked locating plate

### Material

- Steel, chromium plated

### Notes

- 'FS' keys as standard with 'shuttered' keyway. Optionally 'FT', '92' or 'DLP' key types also available
- Cam pawl can be fitted at 45° intervals
- Wide choice of cam pawls, finish options and accessory items available



GA5-G25250

G01905  
(Locking plate)

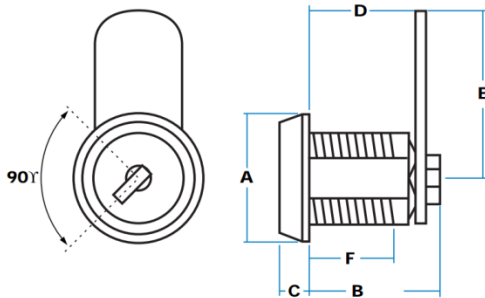

For clarity, retaining nut is not shown

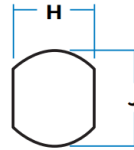

Offset aperture by 45° to compensate for orientation of keyway

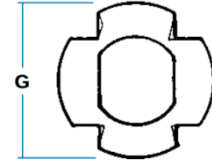

Part No.	Rotation	Key Type	A	B	C	D	E	F	G	H	J
GA5-G25250	90°	Mixed	26	28	6	19	35	15	34	17.5	20
GA5-G25250-01		FS880									

## GA5 Short Body Compartment Lock With 90° Key Removal

### Features

- Also with 90° key-withdrawal, these locks have overall length at 7 mm less than standard. It can be further reduced with optional moulded spacer.

### Material

- Steel, chromium plated

### Notes

- 'FS' key only
- Cam pawl reversible, can be fitted at 45° intervals

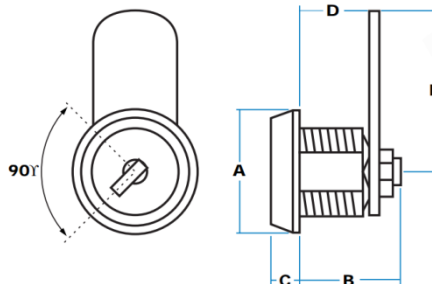

GA5-G00927

Part No.	Opening	Key Type	A	B	C	D	E
GA5-G00927	90°	Mixed	26	20	6	13	35
GA5-G00927-01		FS880					